

NOTICE!!

These documents have been scanned!

Do not place un-scanned documents beneath this notice!

Do not remove this notice from this file!

GPO Jacket No. 560-102
Print Order 61540
Rise Business Services, LLC
Job=AZ15 5/21/2019



Box Number= AZ15074



Claim Begin-End: AMC452853-AMC452853

1 Initial Receipt



AZ15074-3 AMC452850-AMC453499

United States Department of the Interior
Bureau of Land Management
 DIV OF LANDS, MINRLS & ENERGY
 ONE N CENTRAL AVE
 PHOENIX, AZ 85004 -4427
 Phone: 602-417-9200

Receipt

No: 4361071

Transaction #: 4478282	
Date of Transaction: 01/31/2019	
CUSTOMER:	
RICHARD GWYNNE 4750 N GOLD DR APACHE JUNCTION, AZ 85220-9102 US	



LINE #	QTY	DESCRIPTION	REMARKS	UNIT PRICE	TOTAL
1	1.00	LOCATABLE MINERALS / MINING CLAIMS-NEW, UNADJUD, ONE OR MORE AUTH NOS / NEW MINING CLAIM PROCESSING FEE CASES: AMC452853/\$20.00		- n/a -	20.00
2	1.00	LOCATABLE MINERALS / MINING CLAIMS-NEW, UNADJUD, ONE OR MORE AUTH NOS / NEW MINING CLAIMS LOCATION FEE CASES: AMC452853/\$37.00		- n/a -	37.00
3	1.00	LOCATABLE MINERALS / MINING CLAIMS-NEW, UNADJUD, ONE OR MORE AUTH NOS / NEW MINING CLAIMS MAINTENANCE FEE CASES: AMC452853/\$155.00		- n/a -	155.00
TOTAL:					\$212.00

PAYMENT INFORMATION				
1	AMOUNT:	212.00	POSTMARKED:	N/A
	TYPE:	CASH	RECEIVED:	01/31/2019
	NAME:	GWYNNE, RICHARD 4750 N GOLD DR APACHE JUNCTION AZ 85220-9102 US		

REMARKS

This receipt was generated by the automated BLM Collections and Billing System and is a paper representation of a portion of the official electronic record contained therein.

NOTICE!!

These documents have been scanned!

Do not place un-scanned documents beneath this notice!

Do not remove this notice from this file!

GPO Jacket No. 560-102
Print Order 61540
Rise Business Services, LLC
Job=AZ15 5/21/2019



Box Number= AZ15074



Claim Begin-End: AMC452853-AMC452853

2 Correspondence



AZ15074-3

AMC452850-AMC453499

**NO
DOCUMENTS
FOUND**

NO DOCUMENTS FOUND
NO DOCUMENTS FOUND

NOTICE!!

These documents have been scanned!

Do not place un-scanned documents beneath this notice!

Do not remove this notice from this file!

GPO Jacket No. 560-102
Print Order 61540
Rise Business Services, LLC
Job=AZ15 5/21/2019



Box Number= AZ15074



Claim Begin-End: AMC452853-AMC452853

3 Transfers



AZ15074-3

AMC452850-AMC453499

**NO
DOCUMENTS
FOUND**

NO DOCUMENTS FOUND
NO DOCUMENTS FOUND

NOTICE!!

These documents have been scanned!

Do not place un-scanned documents beneath this notice!

Do not remove this notice from this file!

GPO Jacket No. 560-102
Print Order 61540
Rise Business Services, LLC
Job=AZ15 5/21/2019



Box Number= AZ15074



Claim Begin-End: AMC452853-AMC452853

4 Annual Filings



AZ15074-3

AMC452850-AMC453499

Will - Sign - mail

292
JML

Amc 452853
FORM APPROVED
OMB NO. 1004-0114
Expires: January 31, 2020

Form 3830-2
(January 2017)

UNITED STATES
DEPARTMENT OF THE INTERIOR
BUREAU OF LAND MANAGEMENT
MAINTENANCE FEE WAIVER CERTIFICATION

SEE INSTRUCTIONS ON PAGE 2

1. This small miner waiver is filed for the assessment year beginning on September 1, 2019 and ending on September 1, 2020
2. The undersigned and all related parties owned ten or fewer mining claims, mill, or tunnel sites located and maintained on Federal lands in the United States of America on September 1, 2019.
3. The undersigned have performed the assessment work required by law for each mining claim listed prior to filing this waiver and understand that by filing this form, the undersigned must file an affidavit of assessment work with the Bureau of Land Management (BLM) by the December 30th following the filing of this waiver.
4. The undersigned understand that if the assessment work obligation has not yet come due under 30 U.S.C. 28 (for those claims in their first assessment year only), a notice of intent to hold reciting this condition must be recorded by the December 30th following the filing of this waiver.
5. The undersigned understand that mill and tunnel sites may also be listed on this waiver and be waived from payment of the maintenance fee, and that a notice of intent to hold for these sites is required to be filed with the BLM by the December 30th following the filing of this waiver.
6. The undersigned understand and acknowledge that pursuant to 43 U.S.C. 1212 and 18 U.S.C. 1001, the filing or recording of a false, fictitious, or fraudulent document with the BLM may result in a fine of up to \$250,000, a prison term not to exceed five years, or both.
7. The mining claims, mill or tunnel sites for which this waiver from payment of the maintenance fees is requested are:

CLAIM OR SITE NAME	BLM RECORDATION SERIAL NUMBER
1. <u>Will Gwynne</u>	<u>AMC 452853</u>
2.	
3.	
4.	
5.	
6.	
7.	
8.	
9.	
10.	

RECEIVED
BLM AZ STATE OFFICE
2019 AUG 27 P 2:19
PHOENIX, ARIZONA

The owner(s) (claimants) of the above mining claims and sites are:

Will Gwynne ✓ (Owner's Name - Please Print) [Signature] (Owner's Signature)
4750 N. Gold Dr (Owner's Mailing Address) Apache Jct. (City) Az (State) 85120 (Zip Code)

[Signature] (Owner's Name - Please Print) **ENTERED SEP 09 2019** (Owner's Signature)
[Signature] (Owner's Mailing Address) [Signature] (City) [Signature] (State) [Signature] (Zip Code)

Second owner (Owner's Name - Please Print) Signature is on Waiver #2 (Owner's Signature)
Received on 8/22/19 (Owner's Mailing Address) (City) (State) (Zip Code)

(Owner's Name - Please Print) (Owner's Signature)
 (Owner's Mailing Address) (City) (State) (Zip Code)

#1

(Owner's Name - Please Print)	(Owner's Signature)		
(Owner's Mailing Address)	(City)	(State)	(Zip Code)
(Owner's Name - Please Print)	(Owner's Signature)		
(Owner's Mailing Address)	(City)	(State)	(Zip Code)
(Owner's Name - Please Print)	(Owner's Signature)		
(Owner's Mailing Address)	(City)	(State)	(Zip Code)
(Owner's Name - Please Print)	(Owner's Signature)		
(Owner's Mailing Address)	(City)	(State)	(Zip Code)

18 U.S.C. 1001 and 43 U.S.C. 1212 make it a crime for any person knowingly and willfully to make to any department or agency of the United States any false, fictitious or fraudulent statements or representations as to any matter within its jurisdiction.

INSTRUCTIONS

1. This certification is made under the provisions of 43 U.S.C. § 1744 and 30 U.S.C. §28-28k and the regulations thereunder (43 CFR Part 3830).
2. The claimant(s) must fill in the dates in paragraph 1 for the beginning and ending of the assessment year for which this waiver is sought.
3. The claimant(s) must fill in the date in paragraph 2 for the beginning of the assessment year for which this waiver is sought.
4. All claim and site names and BLM serial numbers must be listed for the mining claims, mill sites, and tunnel sites for which the waiver is sought.
5. All owners of the mining claims, mill sites, and tunnel sites and their addresses must be given.
6. This waiver form must be signed by all the claimants or their designated agent, in original form. If an agent is designated, a notarized designation of agent, signed by all of the claimants with proper address given, must be submitted with this waiver.
7. This form must be filed no later than September 1st for the upcoming assessment year in the BLM State Office where the mining claims or sites are recorded, or the waiver cannot be granted by the BLM. (Example: To obtain a waiver for the assessment year 2012, which begins on September 1, 2011, you must qualify for and file for a waiver no later than September 1, 2011, in the proper BLM State Office.)
8. For all mining claims which require assessment work, you must record an affidavit of labor on or before the December 30th immediately following the filing of this waiver. For all other mining claims or sites waived, you must record a notice of intent to hold on or before the December 30th immediately following the filing of this waiver.
9. Mill and tunnel sites may also be listed on this waiver and be waived from payment of the maintenance fee. A notice of intent to hold for these sites is required to be filed by the December 30th following the filing of this waiver.

FOR OFFICIAL USE ONLY

#1500 was turned in within
paperwork at BLM office
my son will and are both on claim

Richard Gwynne
Richard Gwynne
August 22nd 2019

RECEIVED
STATE OFFICE

2019 AUG 22 PM 2:16

**UNITED STATES
DEPARTMENT OF THE INTERIOR**

Bureau of Land Management
Arizona State Office
1 North Central Avenue, Suite 800
Phoenix, Arizona 85004-4427

OFFICIAL BUSINESS
PENALTY FOR PRIVATE USE, \$300

RECEIVED
BLM AZ STATE OFFICE

2019 AUG 27 P 2:

PHOENIX, ARIZONA

PHOENIX AZ 852

26 AUG 2019 PM 3 L

AN EQUAL OPPORTUNITY EMPLOYER

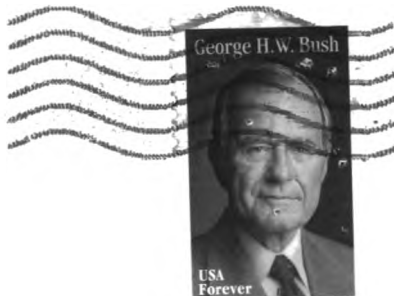

BLM
One N CENTRAL AVE
SUITE 800
PHOENIX AZ 85004

85004-442700



UNITED STATES
DEPARTMENT OF THE INTERIOR
BUREAU OF LAND MANAGEMENT
MAINTENANCE FEE WAIVER CERTIFICATION

Before Sept 1-2019

452853

FORM APPROVED
OMB NO. 1004-0114
Expires: January 31, 2020

292

SEE INSTRUCTIONS ON PAGE 2

1. This small miner waiver is filed for the assessment year beginning on September 1, 2019 and ending on September 1, 2020
2. The undersigned and all related parties owned ten or fewer mining claims, mill, or tunnel sites located and maintained on Federal lands in the United States of America on September 1, 2019
3. The undersigned have performed the assessment work required by law for each mining claim listed prior to filing this waiver and understand that by filing this form, the undersigned must file an affidavit of assessment work with the Bureau of Land Management (BLM) by the December 30th following the filing of this waiver.
4. The undersigned understand that if the assessment work obligation has not yet come due under 30 U.S.C. 28 (for those claims in their first assessment year only), a notice of intent to hold reciting this condition must be recorded by the December 30th following the filing of this waiver.
5. The undersigned understand that mill and tunnel sites may also be listed on this waiver and be waived from payment of the maintenance fee, and that a notice of intent to hold for these sites is required to be filed with the BLM by the December 30th following the filing of this waiver.
6. The undersigned understand and acknowledge that pursuant to 43 U.S.C. 1212 and 18 U.S.C. 1001, the filing or recording of a false, fictitious, or fraudulent document with the BLM may result in a fine of up to \$250,000, a prison term not to exceed five years, or both.
7. The mining claims, mill or tunnel sites for which this waiver from payment of the maintenance fees is requested are:

CLAIM OR SITE NAME	BLM RECORDATION SERIAL NUMBER
1. <u>SALLI ANN</u>	<u>AMC 452853</u>
2.	
3.	
4.	
5.	
6.	
7.	
8.	
9.	
10.	

The owner(s) (claimants) of the above mining claims and sites are:

Richard Gwynne ✓
(Owner's Name - Please Print)
4750 N. Gold Dr
(Owner's Mailing Address)

Richard Gwynne
(Owner's Signature)
Apache Jct AZ 85120
(City) (State) (Zip Code)

(Owner's Name - Please Print)

(Owner's Mailing Address)

(Owner's Signature)

(City) (State) (Zip Code)

(Owner's Name - Please Print)

(Owner's Mailing Address)

AC 483
(Owner's Signature)
ENTERED SEP 09 2019
PH
(City) (State) (Zip Code)

2019 AUG 22 A 10:33
(Owner's Name - Please Print)
RECEIVED BLM AZ STATE OFFICE

(Owner's Mailing Address)

(Owner's Signature)

(City) (State) (Zip Code)

(Continued on page 2)

(#2)

(Owner's Name - Please Print)	(Owner's Signature)
(Owner's Mailing Address)	(City) (State) (Zip Code)
(Owner's Name - Please Print)	(Owner's Signature)
(Owner's Mailing Address)	(City) (State) (Zip Code)
(Owner's Name - Please Print)	(Owner's Signature)
(Owner's Mailing Address)	(City) (State) (Zip Code)
(Owner's Name - Please Print)	(Owner's Signature)
(Owner's Mailing Address)	(City) (State) (Zip Code)

18 U.S.C. 1001 and 43 U.S.C. 1212 make it a crime for any person knowingly and willfully to make to any department or agency of the United States any false, fictitious or fraudulent statements or representations as to any matter within its jurisdiction.

INSTRUCTIONS

1. This certification is made under the provisions of 43 U.S.C. § 1744 and 30 U.S.C. §28-28k and the regulations thereunder (43 CFR Part 3830).
2. The claimant(s) must fill in the dates in paragraph 1 for the beginning and ending of the assessment year for which this waiver is sought.
3. The claimant(s) must fill in the date in paragraph 2 for the beginning of the assessment year for which this waiver is sought.
4. All claim and site names and BLM serial numbers must be listed for the mining claims, mill sites, and tunnel sites for which the waiver is sought.
5. All owners of the mining claims, mill sites, and tunnel sites and their addresses must be given.
6. This waiver form must be signed by all the claimants or their designated agent, in original form. If an agent is designated, a notarized designation of agent, signed by all of the claimants with proper address given, must be submitted with this waiver.
7. This form must be filed no later than September 1st for the upcoming assessment year in the BLM State Office where the mining claims or sites are recorded, or the waiver cannot be granted by the BLM. (Example: To obtain a waiver for the assessment year 2012, which begins on September 1, 2011, you must qualify for and file for a waiver no later than September 1, 2011, in the proper BLM State Office.)
8. For all mining claims which require assessment work, you must record an affidavit of labor on or before the December 30th immediately following the filing of this waiver. For all other mining claims or sites waived, you must record a notice of intent to hold on or before the December 30th immediately following the filing of this waiver.
9. Mill and tunnel sites may also be listed on this waiver and be waived from payment of the maintenance fee. A notice of intent to hold for these sites is required to be filed by the December 30th following the filing of this waiver.

FOR OFFICIAL USE ONLY

RECEIVED
BLM AZ STATE OFFICE
2019 AUG 22 4 10 33

NOTICE!!

These documents have been scanned!

Do not place un-scanned documents beneath this notice!

Do not remove this notice from this file!

GPO Jacket No. 560-102
Print Order 61540
Rise Business Services, LLC
Job=AZ15 5/21/2019



Box Number= AZ15074



Claim Begin-End: AMC452853-AMC452853

5 Miscellaneous



AZ15074-3

AMC452850-AMC453499

**NO
DOCUMENTS
FOUND**

NO DOCUMENTS FOUND
NO DOCUMENTS FOUND

NOTICE!!

These documents have been scanned!

Do not place un-scanned documents beneath this notice!

Do not remove this notice from this file!

GPO Jacket No. 560-102
Print Order 61540
Rise Business Services, LLC
Job=AZ15 5/21/2019



Box Number= AZ15074



Claim Begin-End: AMC452853-AMC452853

6 Location Notices-Amendments and Supporting Documents



AZ15074-3

AMC452850-AMC453499

MINING CLAIM STATUS REPORT

Data Entered: 2/1/2019

MTP Checked By: EG

GEO Checked By: _____

LEAD SERIAL NUMBER: AMC 452853

thru AMC 452853

NUMBER OF CLAIMS & TYPE:

1 LODE
 _____ PLACER
 _____ ASSOCIATION PLACER
 _____ MILL SITE
 _____ TUNNEL SITE

CHARGES:

Processing Fee @ \$20 = \$ 20
 Location Fee @ \$37 = \$ 37
 Maintenance Fee @ \$155 = \$ 155
 Add'l Maint Fee for Assoc Placer = \$ _____
SUBTOTAL \$ 212
 Other Fees \$ _____
 Other Fees \$ _____
TOTAL \$ _____

TOTAL ACREAGE: _____ Per Claim
(Placer Only)

NUMBER OF LOCATORS: 2

DOCUMENTS RECEIVED VIA: Over-the-Counter Mail TIMELY FILED: Yes No

LEGAL DESCRIPTION: T 1S R 10E SEC 7
 T _____ R _____ SEC _____
 T _____ R _____ SEC _____
 T _____ R _____ SEC _____
 T _____ R _____ SEC _____

BLM FOREST SERVICE SUBJ TO PL 359: Yes No
WILDERNESS AREA

SPLIT ESTATE: N/A SX PX OTHER
SRHA Was proper Notice filed if located on SHRA Land? Yes No

RECONVEYED MINERALS ON BLM LAND REQUIRE OPENING ORDER FROM 1944 TO 1993:

Open to Entry On _____ N/A

COMMENTS/STATUS: VOID PARTIALLY VOID PVT MINERALS WITHDRAWN LANDS
OTHER

Claimant acknowledges that portions of the following claim(s) site(s) may be void or voidable.

Printed Name of Claimant _____ Signature of Claimant _____

*****FINAL ADJUDICATION*****

DATE _____ INITIALS _____

AMC 452853

LR2K Home CR-24



LR2000 Internal

CR Geographic Report with Land

[Download User Guide \(pdf\)](#)

Purpose: This report produces a geographic listing of case information based on retrieval by Meridian/Township/Range. This report format will display the case type, case disposition, meridian, township, range, section, survey type, survey number, surface management agency, pending actions, serial number, and total case acres.

To refresh the query, do a **Ctrl-R**. It resets the page and clears any criteria fields that may have entries.



No Results

The specified criteria didn't result in any data. This is often caused by applying filters and/or selection steps that are too restrictive or that contain incorrect values. Please check your analysis filters and selection steps, and try again. The filters or selection steps currently being applied are shown below.

Filters

Disposition is equal to **AUTHORIZED, CANCELLED, EXPIRED, PENDING, REJECTED, RELINQUISHED, WITHDRAWN**
and Meridian Township Range Section is equal to **14 0010S 0100E 007 SE**
and Admin State is equal to **AZ**

[Return - Refresh](#)

LOCATION NOTICE FOR LODE MINING CLAIM

Amendment BLM Serial # _____

NOTICE IS HEREBY GIVEN that the Salli Ann

_____ lode mining claim has been located

by Richard and Will Gwynne whose current mailing

address is 4750 N. Gold Dr.

Apache Junction Az. 85120

The general course of this claim is NE - SW and it is situated in Pinal

County, Arizona. This claim is 1500 feet in length and 600 feet in width.

20 Total Claim Acreage. This claim runs from the location monument on which this location notice

is posted on the centerline of the claim approximately 750 feet in a NE direction to the NE

end line and 750 feet in a SW direction to the SW end line. This claim is marked by six monuments, one at each corner and one at the center of each end line of the claim.

The location monument on which this notice is posted is situated within Section 7, Township 1 South

_____, Range 10 E, Gila Salt River Base and Meridian, Arizona and this claim encompasses portions

of the following quarter section(s), section(s), Township(s) and Range(s) SE Quarter

Section 7 township 1-S Range 10 - E

Gila Salt River Base and Meridian, Arizona.

The locality of this claim with reference to some natural object or permanent monument and additional information

(if any) concerning its locality are as follows: From The Center Post of the Claim

To the USGS Monument NE Corner of section 7

is approx. 18° N and approx 4180 ft apart The above information is shown on the attached map.

DATED AND POSTED on the ground this 30 day of January, 2019.

LOCATOR(s) AGENT

Print Name(s) Richard Gwynne, Will Gwynne

Signature(s) Richard Gwynne

Form MCF100
Revised July 2014

This form is available from the Arizona Geological Survey and may be reproduced.

RECEIVED
BLM AZ STATE OFFICE
2019 JAN 31 P 1:24
PHOENIX, ARIZONA
BLM
Date
Stamp

AMC 45285B

MINING CLAIM MAP

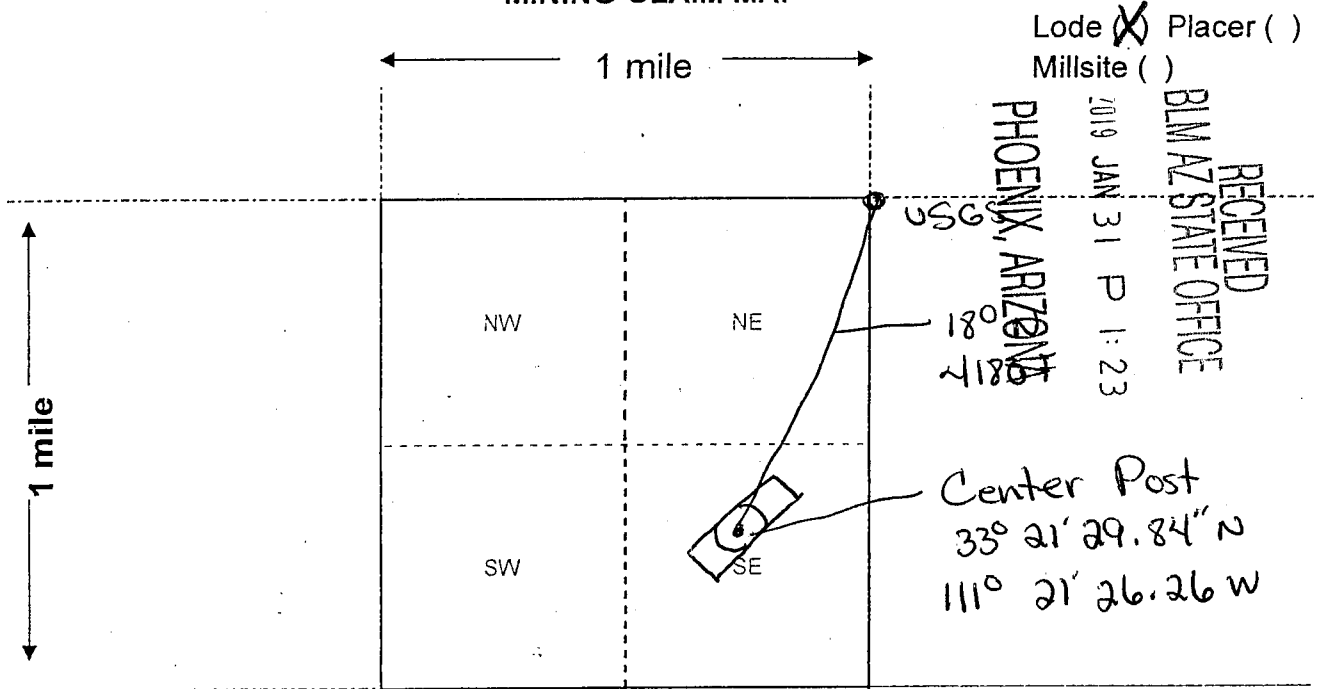

Lode Placer ()
Millsite ()

PHOENIX, ARIZONA

2019 JAN 31 P 1:23

RECEIVED
BLM AZ STATE OFFICE

USGS

180
118.17

Center Post
33° 21' 29.84" N
111° 21' 26.26 W

Scale: 1" = 2000 feet



- The above map depicts the Salli Ann mining claim, which is located in Section (s) 7, Township 1 S, Range 10 E, Gila and Salt River Base and Meridian, Pinal County, Arizona. Total claim acreage is 20
- The type of corner and location monuments used are as follows: White PVC in rock
- The bearings and distances in degrees and feet between claim corners and to a public land survey monument are as depicted on the map. See additional map for more details
- If the claim is a placer or millsite claim with exterior limits conforming to legal subdivisions of the public survey, provide a legal description of the claim _____

AN0452853

Form MCF100a
Revised July 2014

AMC452853

RECEIVED
BLM AZ STATE OFFICE

2019 JAN 31 P 1:23

PHOENIX, ARIZONA

Section 7
Township 1S
Range 10E

